

Colorbond Steel Panel Fencing

NOTES

1. Fences must be built with new materials consisting of double sided Colorbond steel panels in the colour of "Woodland Grey" in matt finish except for any temporary builder's fencing required at law during the construction of a dwelling on the lot.
2. No fence shall be erected on the front boundary of any lot except for any temporary builder's fencing required at law during the construction of a dwelling on the lot, except for lots 239, 240, 241 and 242 which may have a fence on the Bushland Way and Mulla Mulla Way frontage and except for Lot 140 which may have a fence on the Bushland Way frontage for part of its frontage length in accordance with the Golden Grove Stages 7B-8 Fencing Guidelines as amended from time to time.
3. No side or dividing boundary fencing is permitted within 4 metres of the front boundary along any road frontage, with the exception of the following:
 - The south boundary of Lot 203;
 - The southeast boundary of Lot 244;
 - The northwest boundary of Lot 245;
 - The southeast boundary of Lot 248;
 - The southeast boundary of Lot 265; and
 - The northwest boundary of Lot 266.
4. Fences shall not exceed the height of two (2) metres.

Fence Guidelines Golden Grove Estate Stage 7B & Stage 8		Date	19/08/2024	Sheet	1 of 2
		Drawing No.	309300-V9-FENCE-ST7B	Version	3
		CAD Ref.	G:\30\309300\PLANNING\ACAD		
		Drawn By	SP	Checked By	RJ
Co-ordinate Datum	Scale A3	 Lengths are in metres			
MGA55	1 : 750	REV	AMENDMENT	APPROVED	DATE



16 Bridge Street
PO Box 1064
Bendigo Vic 3550
T 61 3 5448 2500
spiire.com.au

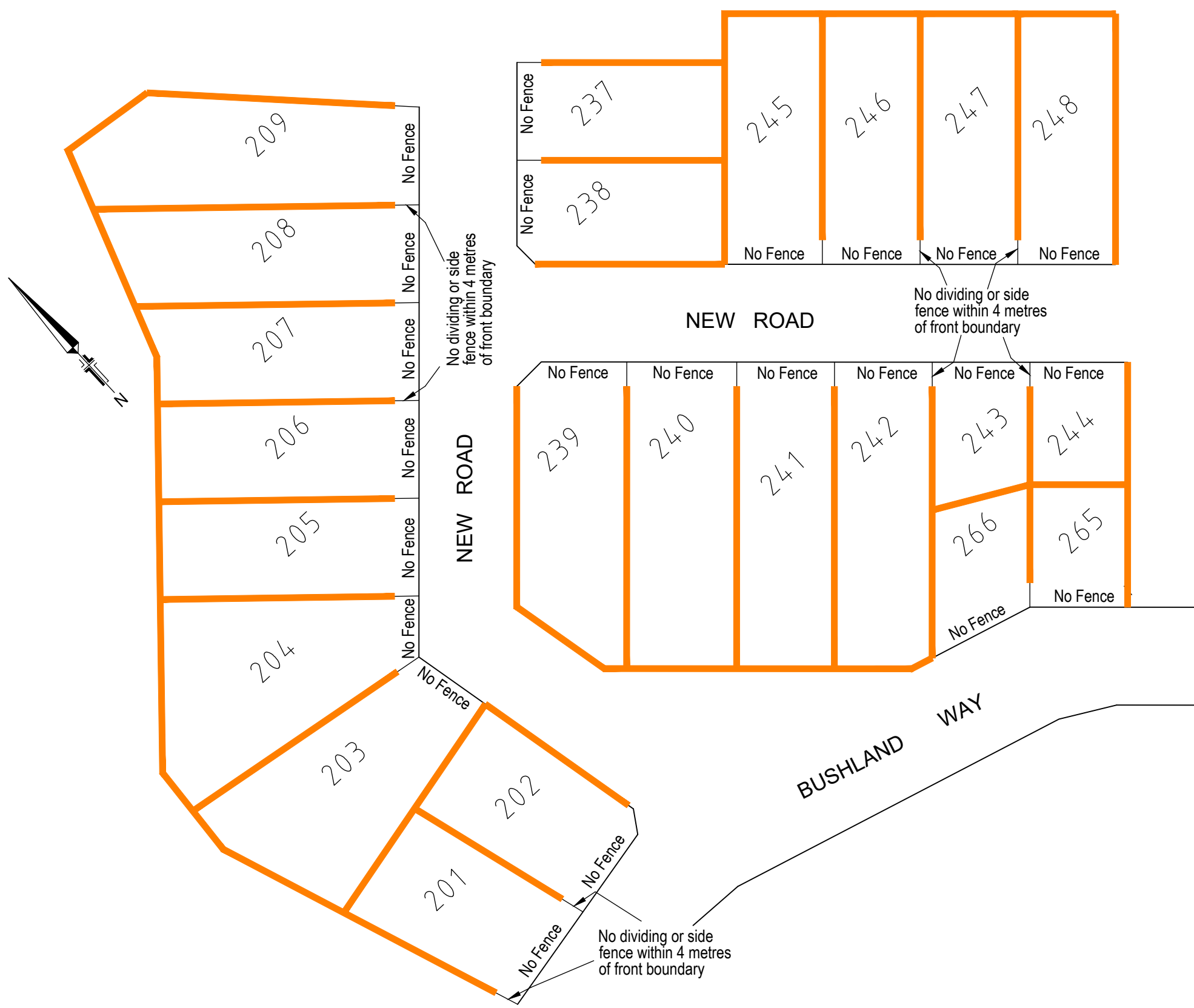

Colorbond Steel Panel Fencing

NOTES

1. Fences must be built with new materials consisting of double sided Colorbond steel panels in the colour of "Woodland Grey" in matt finish except for any temporary builder's fencing required at law during the construction of a dwelling on the lot.
2. No fence shall be erected on the front boundary of any lot except for any temporary builder's fencing required at law during the construction of a dwelling on the lot, except for lots 239, 240, 241 and 242 which may have a fence on the Bushland Way and Mulla Mulla Way frontage and except for Lot 140 which may have a fence on the Bushland Way frontage for part of its frontage length in accordance with the Golden Grove Stages 7B-8 Fencing Guidelines as amended from time to time.
3. No side or dividing boundary fencing is permitted within 4 metres of the front boundary along any road frontage, with the exception of the following:
 - The south boundary of Lot 203;
 - The southeast boundary of Lot 244;
 - The northwest boundary of Lot 245;
 - The southeast boundary of Lot 248;
 - The southeast boundary of Lot 265; and
 - The northwest boundary of Lot 266.
4. Fences shall not exceed the height of two (2) metres.

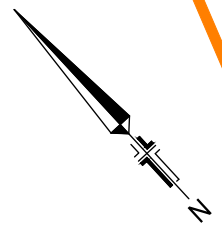

Fence Guidelines Golden Grove Estate - Stage 8		Date	19/09/2024	Sheet	2 of 2
		Drawing No.	309300-V9-FENCE-ST8	Version 3	
		CAD Ref.	G:\30\309300\PLANNING\ACAD		
		Drawn By	SP	Checked By	RJ
Co-ordinate Datum	Scale A3				
MGA55	1 : 750	Lengths are in metres			
REV	AMENDMENT	APPROVED	DATE		

16 Bridge Street
PO Box 1064
Bendigo Vic 3550
T 61 3 5448 2500
spiire.com.au